

11 EN 362 / EN 12275 - MODELS CHART

Table with columns: Ref. No., 'A', Material, Ref. No., 'A', Material, Ref. No., 'A', Material. Lists various connector models like 3C536, 3C595, 2C408, etc., with materials such as Steel, Stainless steel, Light alloy.

12 EN 566 - MODELS CHART

Table with columns: Ref. No., Material, Ref. No., Material, Ref. No., Material. Lists various slings and connectors like 7W100012, 7W099017, 7W102012, etc., with materials like Polyamide, Dyneema (PE), Dyneema (PE) Polyamide.

A DEVICE IDENTIFICATION SHEET

Form for device identification with fields for Trademark, Manufacturer, Product, User, Serial number, Purchase date, etc. Includes CT logo and AFNOR certification logo.

ITALIANO and FRANCAIS sections containing specific instructions for use, warnings, and maintenance for the devices.

ISTRUZIONI D'USO GENERALI

ADDETTAMENTO E FORMA FISICA. L'attività legata all'uso di questo dispositivo sono potenzialmente pericolose... Istruzioni di sicurezza e avvertenze.

1) INSTRUCTIONS AVANT UTILISATION. Lire et comprendre les instructions... 2) INSTRUCTIONS AVANT UTILISATION. Avant l'utilisation, lire et comprendre les instructions... 3) DISPOSITIVI A USO PERSONALE. Ciascun dispositivo è da considerarsi per uso strettamente personale...

13 FASTENERS FOR SLINGS - INSTRUCTIONS FOR USE

Diagrammatic instructions for using fasteners for slings, showing various types of fasteners and their correct application to slings.

5 NOMENCLATURE OF PARTS

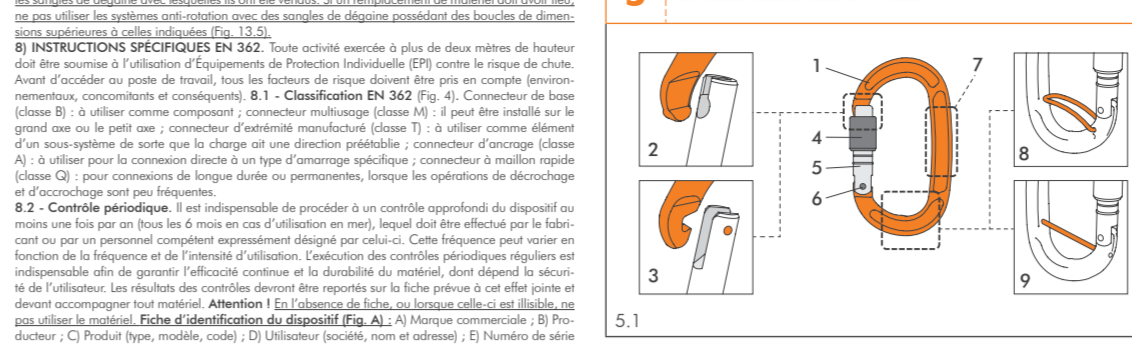

6 LOCKING SYSTEMS TYPOLOGY - INSTRUCTIONS FOR USE

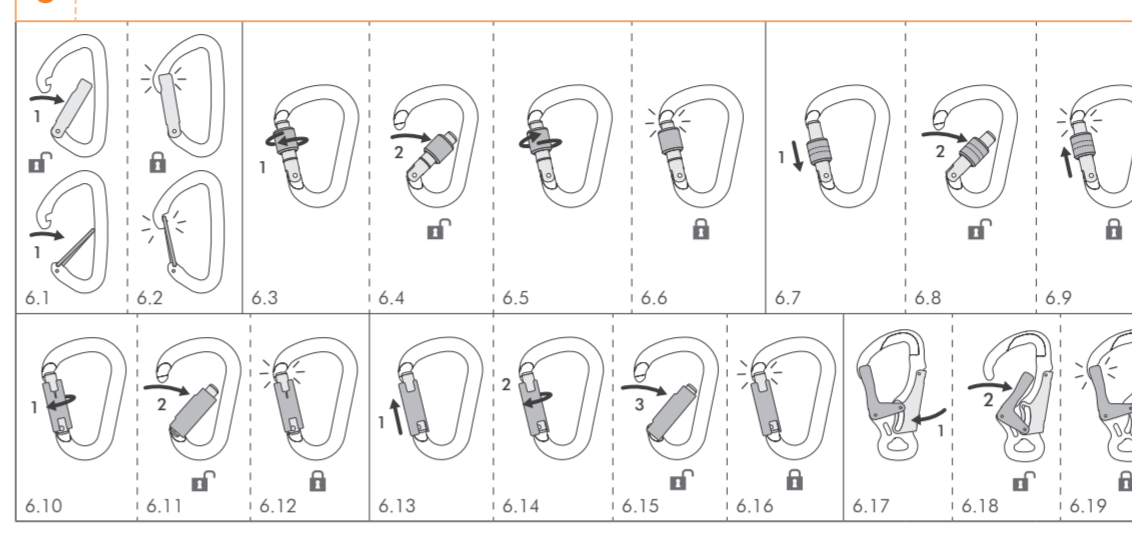

7 EN 12275 / EN 362 - CHECKS / INSTRUCTIONS FOR USE OF THE CONNECTORS

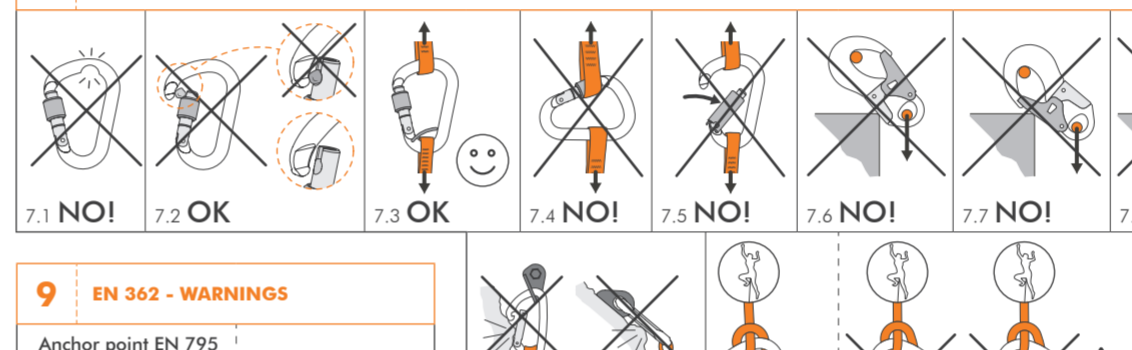

9 EN 362 - WARNINGS



8 EN 12275 / EN 566 - INSTRUCTIONS FOR USE OF THE QUICKDRAWS

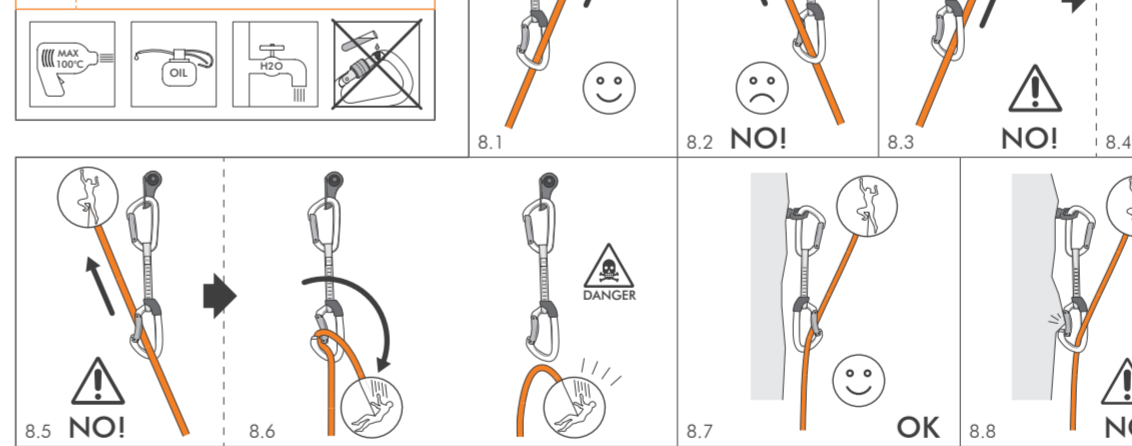

10 WARNINGS

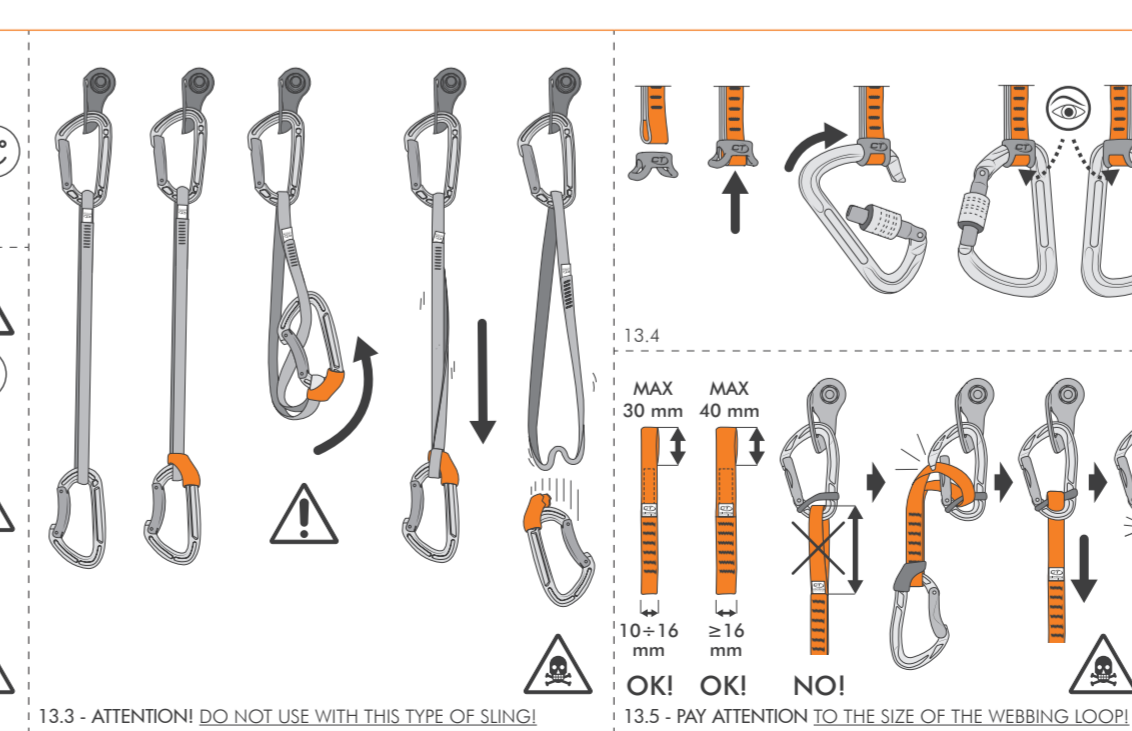

5 INSTRUCTIONS SPECIFIC EN 362

ATTENZIONE! Utilizzare i differenti sistemi anti-rotazione esclusivamente come illustrati... Istruzioni specifiche per il modello EN 362.

EN 12275 - EN 566 - EN 362:2004 INDIVIDUALLY TESTED CONNECTORS MADE IN ITALY

89/686/CEE - Personal Protective Equipment against falls from a height. CE 0333 CE 0639. CT Climbing Technology logo.

1 EN 362 / TRACEABILITY



2 LEGEND



3 MARKING / BREAKING LOADS

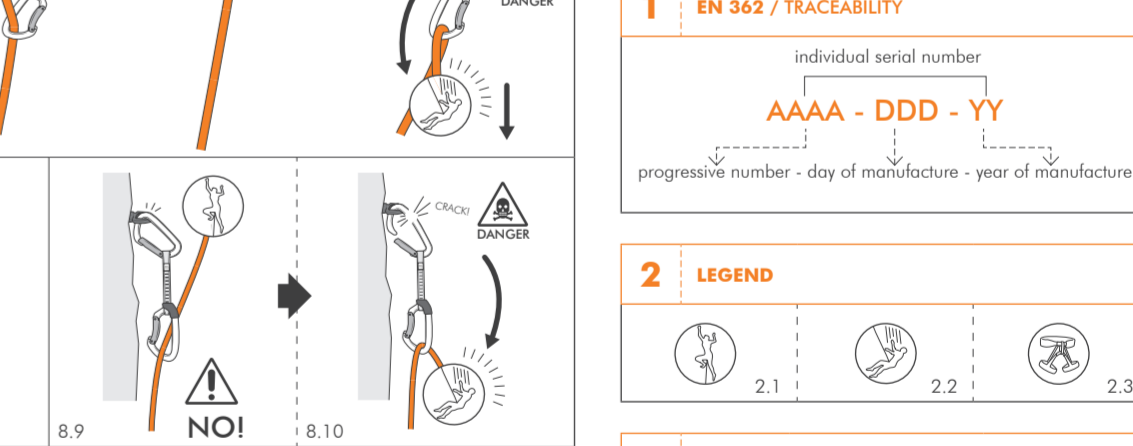

4 CLASSIFICATION OF CONNECTORS

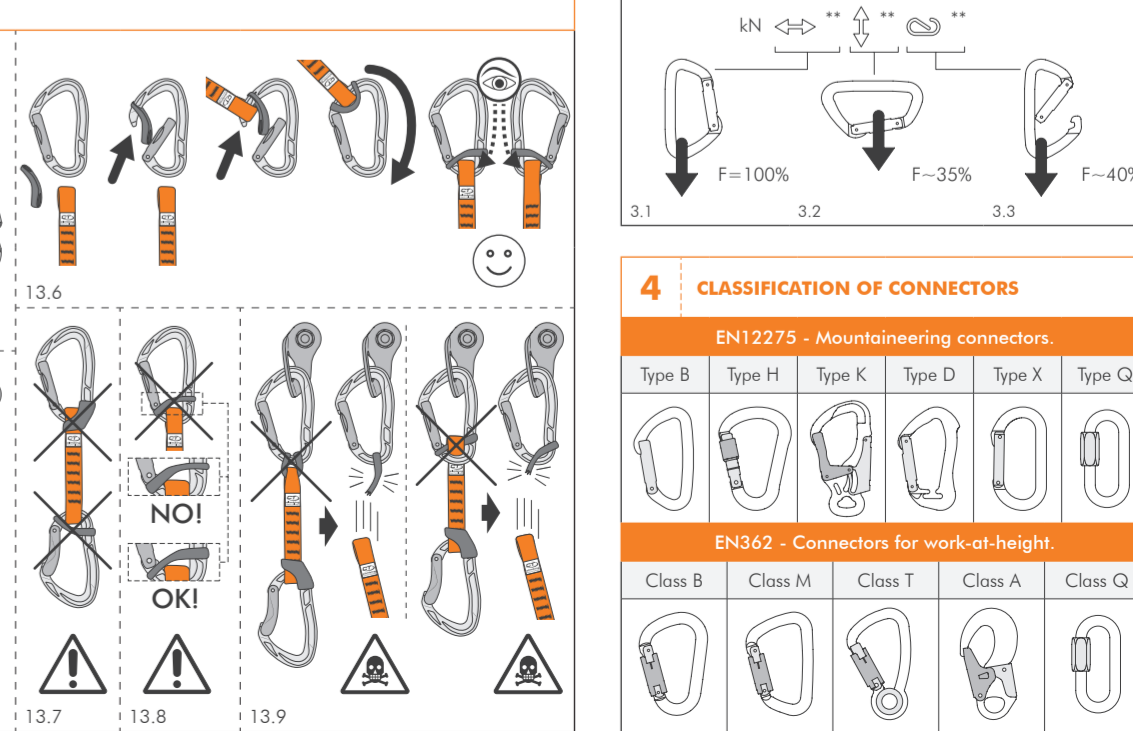

ISTRUZIONI D'USO GENERALI

ADDETTAMENTO E FORMA FISICA. L'attività legata all'uso di questo dispositivo sono potenzialmente pericolose... Istruzioni di sicurezza e avvertenze.

13 FASTENERS FOR SLINGS - INSTRUCTIONS FOR USE

ISTRUZIONI GENERALI PER L'UTILIZZO. Pour de plus amples informations, d'autres langues... Istruzioni generali per l'uso dei fasteners.

13.3 - ATTENTION! DO NOT USE WITH THIS TYPE OF SLING!



13.5 - PAY ATTENTION TO THE SIZE OF THE WEBBING LOOP!

